



## DEMENTIA PATIENT MANAGEMENT AND ACCESS CONTROL



The PROTEGGO system allows you to monitor and manage the movements of disoriented patients. Ideal for managing patients prone to straying, affected by illnesses such as Alzheimer's or dementia.

Supports care staff by notifying them of unauthorised movement of patients, detecting both leaving authorised zones or perimeters and moving away from their bed or chair.

### TARGET MARKETS & BENEFITS



#### Health and Care

Safety equipment for nursing and residential care homes, Alzheimer's centres: PROTEGGO continuously monitors access points or critical areas (entrances, doors, gates, hazardous areas) and alerts staff when a disoriented patient approaches the perimeter or critical area.

### SOLUTIONS

**WITHOUT PATIENT IDENTIFICATION:** Detection of breach of perimeter **without** patient details.

**WITH PATIENT IDENTIFICATION:** Detection of breach of perimeter **with** patient details.

### MAIN COMPONENTS



#### SMILE-ID:

Wristband to detect exit from authorised areas or perimeters. Easy to wash and sanitise. IP67 protection rating



#### D-POS II:

Detects exit from authorised zones



#### D-POS-ANT:

Ferrite antenna for door monitoring (to be used with D-POS II)

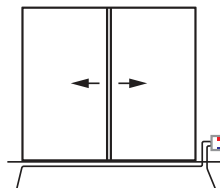

#### LOOP KIT:

Alternative to D-POS-ANT for monitoring of wide exits (to be used with D-POS II)



#### D-TECT:







Detects status and signal from SMILE-ID wristband (with identifier). INFORMO IP Server required



## EFFECTIVE AND NON-INVASIVE MONITORING



### TYPICAL CONFIGURATIONS

TYPE	COMPONENT	WITHOUT PATIENT IDENTIFIER	WITH PATIENT IDENTIFIER	DESCRIPTION AND FUNCTION
Personal monitoring device	SMILE-ID 	✓	✓	Wristband with RFID transmitter. Device for individual patients to detect access to unauthorised areas or exits
Door/exit monitoring unit	D-POS II 	✓	✓	Manages door/exit monitoring connected to the D-POS-ANT ferrite antenna or to the LOOP KIT
Receiver	D-TECT 		✓	SMILE-ID signal receiver. Detects the status of the SMILE-ID wristband and interfaces with the INFORMO IP Central Server
Central Server	informoip 		✓	INFORMO IP: Central Server monitoring and transmitting alarms. Receives, manages and transmits alarms on the move
<b>Options</b>				
Accessory for door monitoring	D-POS-ANT 	✓	✓	Ferrite antenna for door monitoring. Paired with the D-POS II, monitors approaches to the door
Accessory for large exit control	LOOP KIT 	✓	✓	Adapter for wide exits. Paired with the D-POS II monitors the approach to the exit
Personal monitoring transmitter	BED Sensor / CHAIR Sensor  (requires WIOR device)	✓	✓	Bed or chair occupancy motion sensor

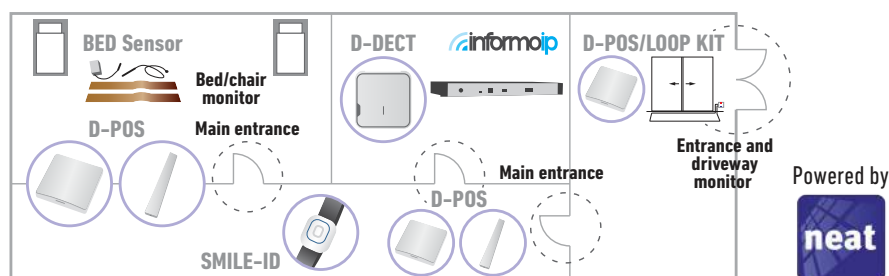

### OPERATION

The system generates an alarm when the monitored exits detect the approach of an unauthorised patient equipped with a SMILE-ID wristband. Notification methods vary depending on the type of monitoring implemented.

**WITHOUT PATIENT ID:** D-POS II, via free contact, generates a signal to the connected notification devices (e.g. light, audible alarm) indicating the breach of the exit and the identifier for the exit.

**WITH PATIENT ID:** D-TECT Receiver detects the breached exit and the identity of the person, forwarding them to the INFORMO IP Central Server, which will manage and send this alarm information to care staff on mobile devices.

### TYPE OF EXITS MONITORED

**PEDESTRIAN DOORS OR ACCESS POINTS:** Using the D-POS-ANT ferrite antenna in conjunction with the D-POS II monitoring unit.

**DRIVEWAYS OR LARGE EXITS:** Using the LOOP KIT (combined with the D-POS II monitoring unit) and its spiral cable, to be buried or hidden.

### PERSONAL DEVICES

**SMILE-ID:** Wristband that can be washed and sanitised, with tear-resistant option.

**BED / CHAIR Sensor:** Sensors detect the patient getting out of the bed or chair, sending an outgoing alarm.

#### TECNEL WIRELESS COMMUNICATION s.r.l.s.

Via Giuseppe di Vittorio n. 70  
20026 Novate Milanese (MI)  
Phone: +39 02 334 841  
Email: [info@tecnel.com](mailto:info@tecnel.com)  
Web: [www.tecnel.com](http://www.tecnel.com)



#### RESELLER'S STAMP